



28 Tintagel Close, Andover, SP10 4DA
Guide Price £230,000



28 Tintagel Close, Andover, Guide Price £230,000

PROPERTY DESCRIPTION BY Miss Molly Scruton

NO CHAIN Situated on Tintagel Close, Andover, this end terrace house presents a wonderful opportunity for those looking to create their ideal home. The property features spacious reception rooms, providing ample space for both relaxation and entertaining. The separate lounge offers a comfortable retreat, while the kitchen diner is perfect for family meals and gatherings.

Upstairs, you will find three well-proportioned bedrooms, ideal for a growing family or for those needing extra space. The family bathroom is conveniently located to serve all bedrooms. Additionally, the property boasts an entrance porch and a downstairs cloakroom with a WC, enhancing the practicality of the home.

The rear garden offers a private outdoor space is low maintenance with a large patio area and plant and shrub borders also benefiting from rear gate access.





Andover offers a good range of shopping and recreational facilities including a theatre, cinema, new leisure centre, excellent selection of schools and a college for higher education. An abundance of open space and land with a selection of local nature reserve's all within walking distance of the town centre. The town itself boasts a lovely "market town" feel and everything you may need is close at hand. The mainline train station offers a fast service to London Waterloo in just over an hour, and the A303 gives access to London via the M3 and the West Country.



Tintagel Close, SP10

Approximate Gross Internal Area = 88.4 sq m / 951 sq ft
 Shed = 2.1 sq m / 23 sq ft
 Total = 90.5 sq m / 974 sq ft

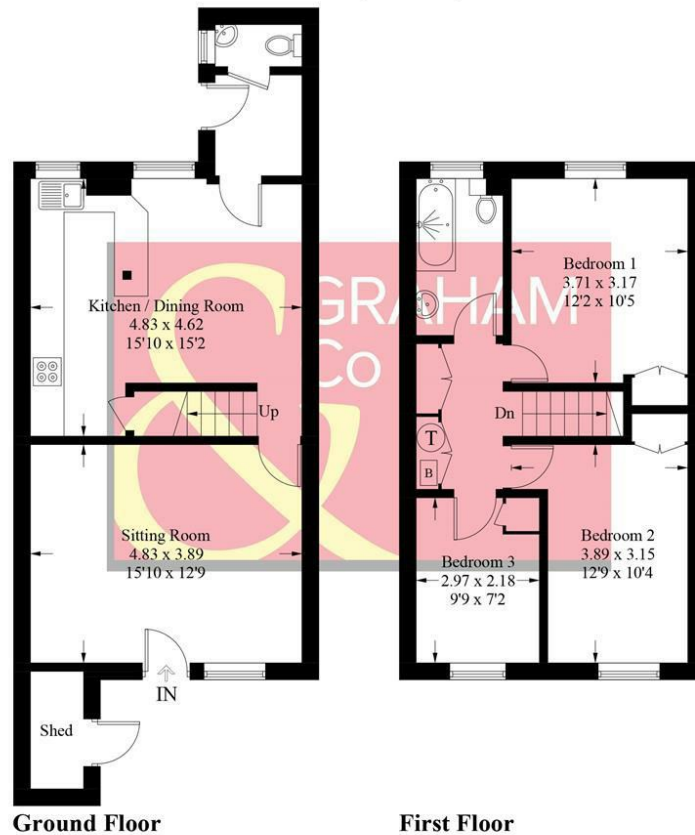

Ground Floor

First Floor

PRODUCED FOR GRAHAM AND CO

Whilst every attempt has been made to ensure the accuracy of the floorplan, measurements of doors, windows and rooms are approximate. These plans are for representation purposes only as defined by RICS Code of Measuring Practice and used as such by any prospective purchaser. © Emzo Marketing (ID1222216)

MORTGAGE ADVICE

Across The Market Mortgages

An independent Mortgage brokerage offering expert advice from across the whole market. Whether you are a first-time buyer, home mover, remortgaging or buying a Buy-To-Let investment. Tristan can provide expert & reliable advice, in a clear jargon free language. Book a free consultation today.

E - tristan@atmmortgages.com M - 07545320380

www.atmmortgages.com

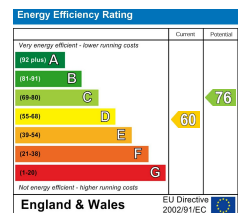

Tax Band: B



OPEN 7 DAYS

If you are considering selling your home please contact us today for your free no obligation valuation

01264 356500

IMPORTANT: we would like to inform prospective purchasers that these sales particulars have been prepared as a general guide only. A detailed survey has not been carried out, nor the services, appliances and fittings tested. Room sizes should not be relied upon for furnishing purposes and are approximate. If floor plans are included, they are for guidance only and illustration purposes only and may not be to scale. If there are any important matters likely to affect your decision to buy, please contact us before viewing the property.